

# P-alert Earthquake P-wave Detector

Hardware System Installation Instruction



- Version 1.01 2015/03.18
- Automation Division, San Lien Technology Crop.
- 3F, No.190, Sec. 2, Zhongxing Rd., Xindian Dist.,  
New Taipei City, 23146 Taiwan.
- TEL:886-2-86659813 FAX:886-2-86659814

# **Install PALERT Hardware**

## **Basic Environment Required:**

- 1. Power: 110 v indoor power**
- 2. Ethernet : RJ45 port with IP address attached**
- 3. Sturdy Building (ex: Wall, Beam, column)**

## **Installation Items Required:**

- 1. PALERT**
- 2. DC24V Adaptor**
- 3. RJ45 Ethernet Cable**  
(There jumper cable network can connect PC with PALERT directly, or you must go through HUB)
- 4. Cross-Head and SHCS Screw Driver, Automation Screw Driver**
- 5. Wall Frame and PALERT Back Board.**
- 6. SHCS screws, Common Screws and Plastic(or metal) Anchor Screws, M4 screws.**
- 7. Hammer, Bubble level meter, Pen.**

**(tools Photo see as next 3 pages)**





## Installation steps:

1. Find the north direction of the installed room.  
the PALERT b-axis will be aligned that direction.

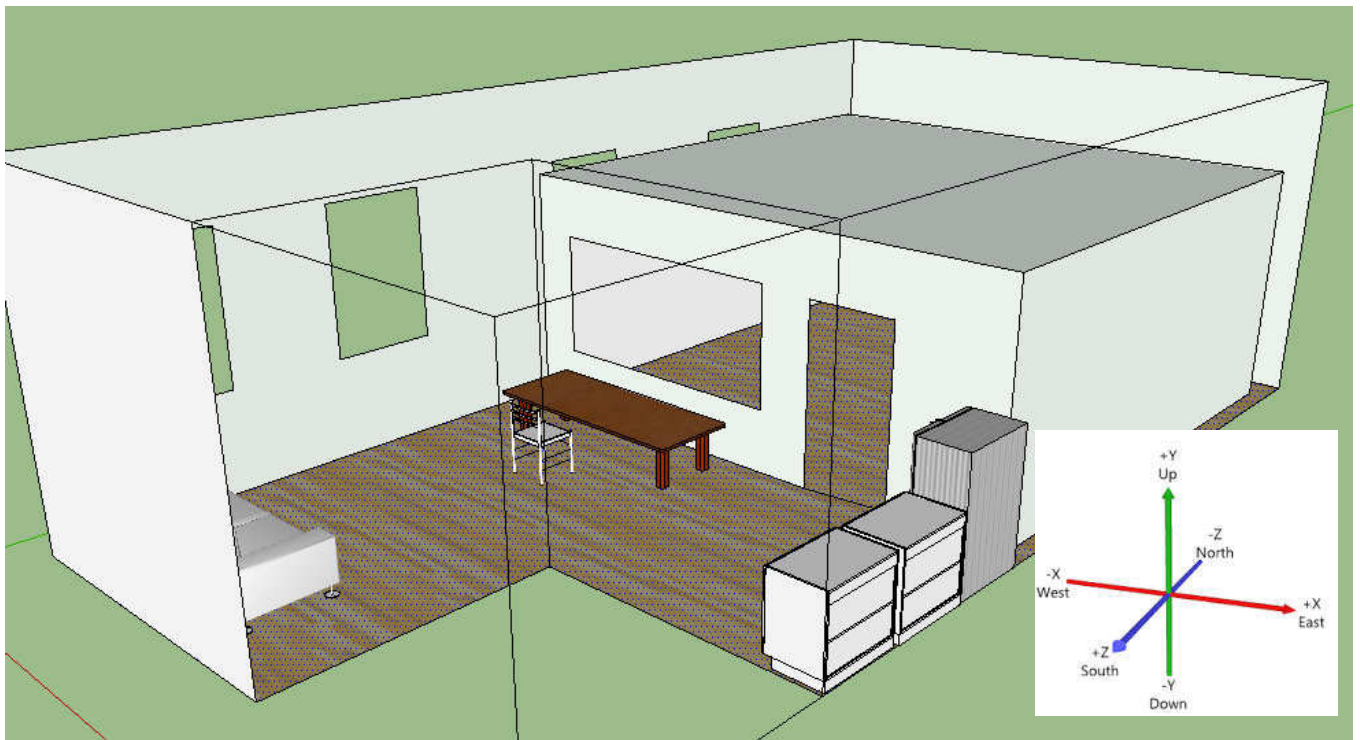
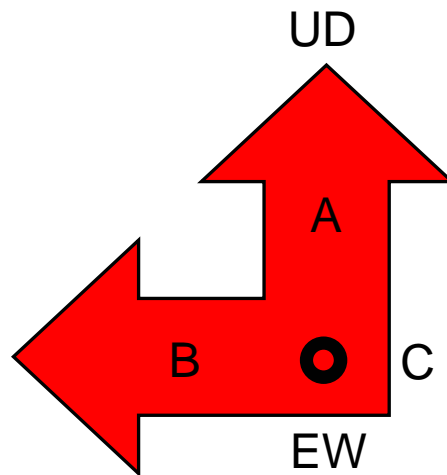
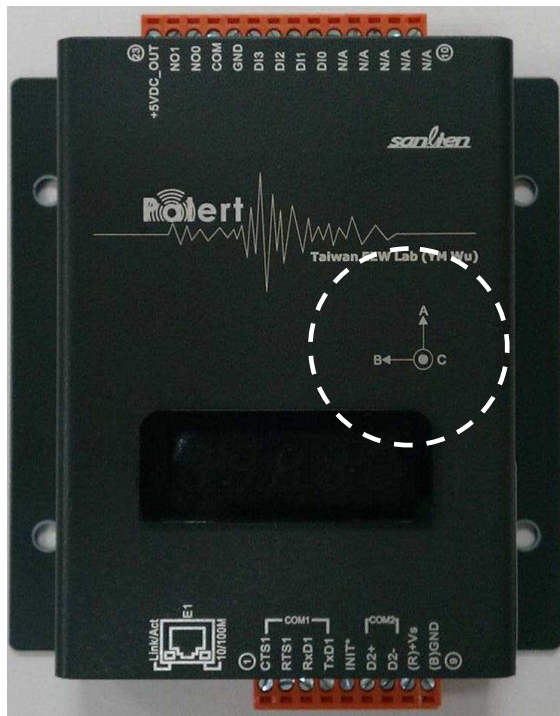

**2. Select the wall (column) that PALERT wants to fixed on it.**

**To determine the true seismic wave, suggest the wall installed should be concrete or SRC material.**



**Sturdy wall can makes seismic wave performance better!!**

**3. Using bubble level meter measure the leveling of PALERT frame fixed place.**





**4. Marking 4 dots with pen through frame hole and drill the 4 holes at that dots by automation screw driver.**

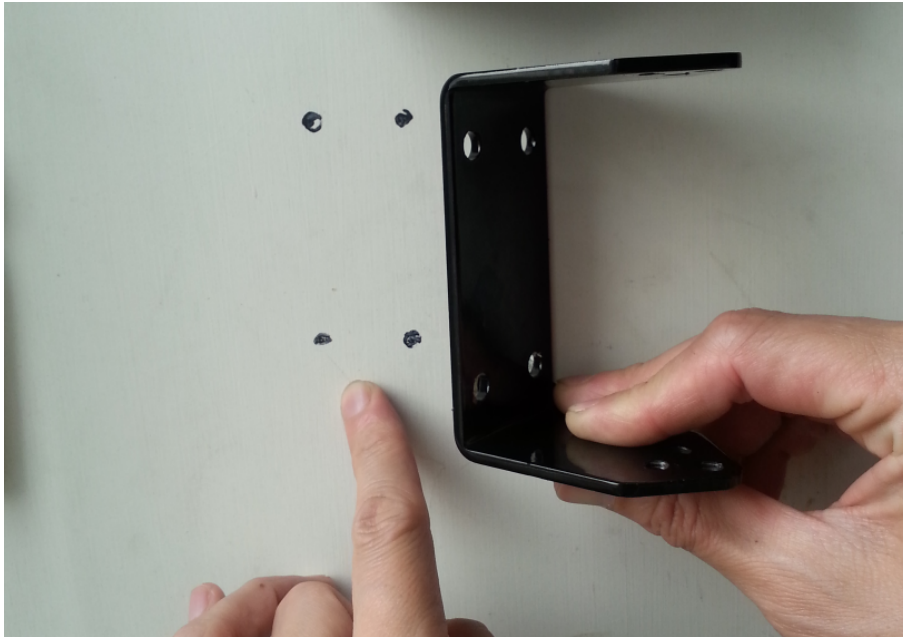



**5. Hit plastic (metal) anchor screws into the drilled hole, then locked the PALERT frame on the wall with common screw. (see as next page)**



or





**Outsides the wall:**

**Insides the wall :**  
**The sequence form inner**  
**to outer wall are plastic**  
**anchor screw, wall,**  
**common screw.**

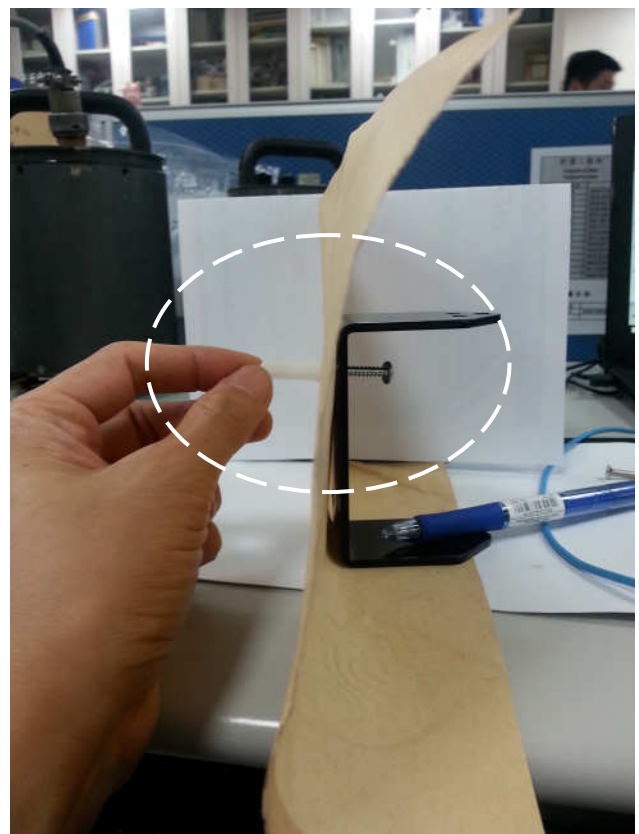

**5. Screwing the SHCS screw between the back board and the frame.**

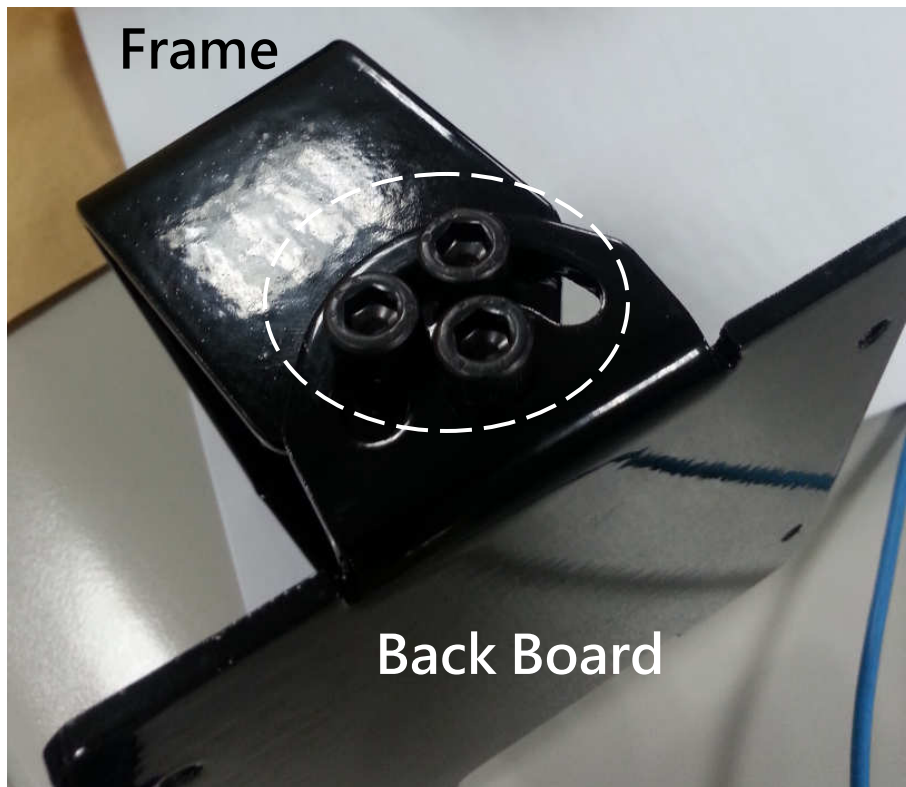

## 5. Locking the PALERT on the back board with the M4 screws.



**6. Connect the power and Ethernet cable and then finished the PALERT hardware installation.**

